

vtech[®]

User's Manual

3-in-1 Musical Band™



© 2010 VTech
Printed in China
91-002483-000

Dear Parent,

At **VTech**[®], we know how important the first day of school is for your child. To help prepare preschoolers for this important event, **VTech**[®] has developed the **Preschool Learning**[™] series of interactive toys.

Preschool Learning[™] features fun characters and inviting school themes that use technology to capture a child's attention and teach important preschool skills like spelling, counting and the alphabet. These vital skills are taught in a way that's both fun and highly engaging to maintain a child's interest. Children will also be introduced to fun school subjects such as art class, music class and even recess! With **Preschool Learning**[™], learning is fun from day one!

At **VTech**[®], we know that a child has the ability to do great things. That's why all of our electronic learning products are uniquely designed to develop a child's mind and allow them to learn to the best of their ability. We thank you for trusting **VTech**[®] with the important job of helping your child learn and grow!

Sincerely,

Your friends at **VTech**[®]

To learn more about **Preschool Learning**[™] series and other **VTech**[®] toys, visit www.vtechkids.com

INTRODUCTION

Thank you for purchasing the **VTech® 3-in-1 Musical Band™!**

The **3-in-1 Musical Band™** is an interactive musical instrument that lets you record your very own songs. With easy transformation between guitar and piano, 3 child-friendly tunes in 3 musical styles and lots of rhythms and sound effects to choose from, the musical possibilities are endless.

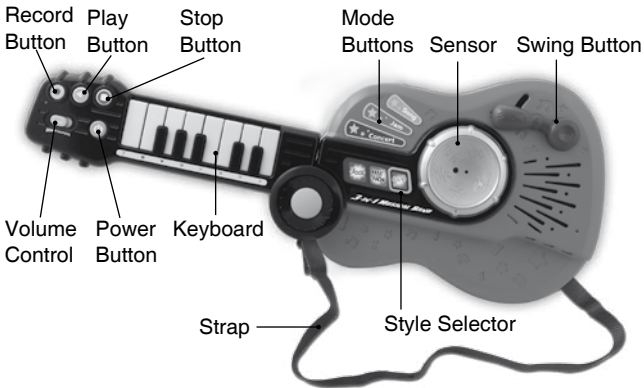

INCLUDED IN THIS PACKAGE

- One VTech® 3-in-1 Musical Band™ learning toy
- One user's manual
- One guitar strap

WARNING: All packing materials such as tape, plastic sheets, wire ties and tags are not part of this toy, and should be discarded for your child's safety.

GETTING STARTED

BATTERY INSTALLATION

1. Make sure the unit is **OFF**.
2. Locate the battery cover on the bottom of the unit.
3. Install 3 new “AA” size (AM-3/LR6) batteries following the diagram inside the battery box. (The use of new alkaline batteries is recommended for maximum performance.)
4. Replace the battery cover.

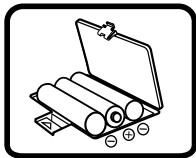

BATTERY NOTICE

- The use of new alkaline batteries is recommended for maximum performance.
- Non-rechargeable batteries are not to be recharged.
- Rechargeable batteries are to be removed from the toy before being charged (if removable).
- Rechargeable batteries are only to be charged under adult supervision (if removable).
- Do not mix old and new batteries.
- Do not mix batteries of different types: alkaline, standard (carbon-zinc) or rechargeable (nickel-cadmium).
- Only batteries of the same or equivalent type as recommended are to be used.
- Batteries are to be inserted with the correct polarity.
- Exhausted batteries are to be removed from the toy.
- The supply terminals are not to be short-circuited.
- The toy is not to be connected to more than the recommended number of power supplies.
- Do not dispose of batteries in fire.

WE DO NOT RECOMMEND THE USE OF RECHARGEABLE BATTERIES.

REMOVE DEMO TAG

The demo tag should be removed immediately when the product is taken out of the packaging. If the demo tag is still in position when you begin play, please remove it from the bottom of the unit to activate normal play mode.

GUITAR STRAP INSTALLATION

Insert the guitar strap at the back of the guitar

A. To fasten one end of the strap on the right side:

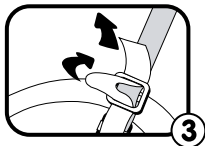
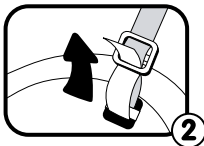
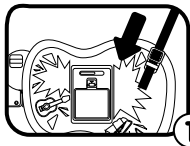

B. To fasten the other end of the strap on the left side:

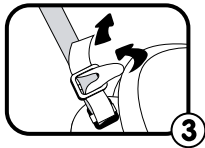
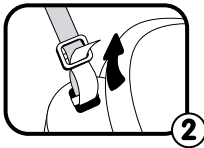
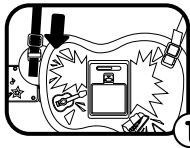

PRODUCT FEATURES

Power Button

Press the Power button to turn the unit on. Press it again to turn the unit off.

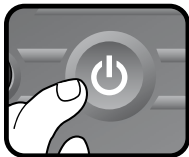

Mode Buttons

Press the Mode buttons to enter “Song”, “Jam” or “Concert” modes.

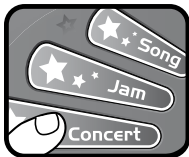

Style Selector

Slide the Style Selector to change the musical style of the songs and music.

There are 3 styles to choose from: Rock, Hip Hop and Jazz.



Sensor

Move your hand over the Sensor to add drum sounds, rhythm or other musical sounds in different modes.



Swing Button

Slide the Swing Button to add sound effects or rhythm to your music in different modes.



Keyboard

Press a key on the Keyboard to hear music notes or sound effects in different modes. Turn the Keyboard to change between Guitar and Piano modes.

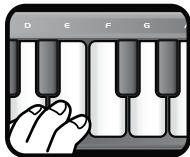

Volume Control

Slide the Volume Control to adjust the volume. There are 3 volume levels to choose from.

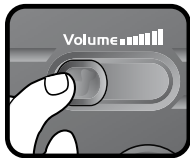

Stop Button

Press the Stop Button to stop recording, stop a song or music, or stop the playback of a recorded track.

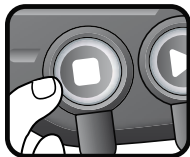

Play Button

Press the Play Button to play your recorded song. When playing a song, the light next to the Record button will stay lit.

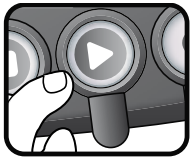

Record Button

Press the Record Button to start recording. If you run out of recording space, you will be notified. During recording, the light next to the Record button will flash.

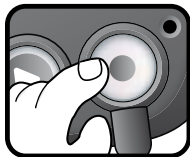

Guitar/Piano Transformation

The **3-in-1 Musical Band™** can transform into a Guitar or Piano. To transform the **3-in-1 Musical Band™**, press and hold the yellow Vtech™ button, then swing the keyboard into position as shown below. When it is a piano, the Sensor works as a drum. When it is a guitar, use the Sensor to strum.

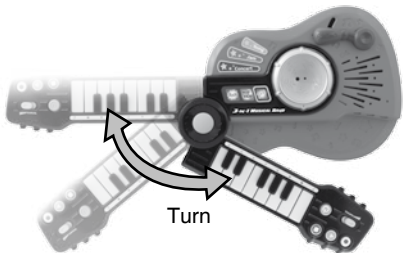
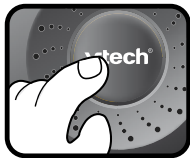

(The 3-in-1 Musical Band may not operate correctly if the batteries are low. In this case, please replace the batteries.)

ACTIVITIES

GUITAR SHAPE

Song Mode

When you enter this mode, a song will play in the current musical style. (Choose the musical style by sliding the Style Selector.)

To start a song, press any Keyboard key or move your hand over the Sensor.

When a song is playing, add sound effects to the song by pressing the keys on the Keyboard, sliding the Swing Button or moving your hand over the Sensor.

Jam Mode

Press a key on the Keyboard to hear a music note.

Strum your hand over the Sensor to play a rhythm in the current musical style. (Choose the musical style by sliding the Style Selector.)

Slide the Swing Button to add a sound effect in the current musical style.

Concert Mode

When you enter this mode, a drum rhythm will play.

Keep strumming the Sensor to add bass guitar to the drum rhythm.

Press and hold a Keyboard key to add more sounds to the drum rhythm.

Slide the Swing Button to add sound effects to the music.

The drum rhythm, bass guitar line, all Keyboard instruments and Swing Button sound effects are in the current musical style. (Choose the musical style by sliding the Style Selector.)

PIANO SHAPE

Song Mode

When you enter this mode, a song will play in the current musical style. (Choose the musical style by sliding the Style Selector.)

To start a song, press any piano key or move your hand over the Sensor.

When a song is playing, add sound effects to the song by pressing Keyboard keys or sliding the Swing Button.

Move your hand over the Sensor to add drum sounds to the song.

Jam Mode

Press a key on the Keyboard to hear a piano note.

Move your hand over the Sensor to add drum sounds to the song.

Keep sliding the Swing Button to hear a rhythm in the current musical style. (Choose the musical style by sliding the Style Selector.)

Concert Mode

When you enter this mode, a drum and bass rhythm will play.

Press and hold a Keyboard key to add more instruments to the drum and bass rhythm.

Slide the Swing Button to add a piano slide sound effect to the music.

Move your hand over the Sensor to add drum sounds to the song.

The drum and bass rhythm and all Keyboard key sound effects are in the current musical style. (Choose the musical style by sliding the Style Selector.)

CARE & MAINTENANCE

1. Keep the unit clean by wiping it with a slightly damp cloth.
2. Keep the unit out of direct sunlight and away from any direct heat source.
3. Remove the batteries when the unit is not in use for an extended period of time.
4. Do not drop the unit on hard surfaces and do not expose the unit to moisture or water.

TROUBLESHOOTING

If for some reason the program/activity stops working, then please follow these steps:

1. Turn the unit OFF.
2. Interrupt the power supply by removing the batteries.
3. Let the unit stand for a few minutes, then replace the batteries.
4. Turn the unit back ON. The unit will now be ready to play again.
5. If the unit still does not work, replace with an entire set of new batteries.

If the problem persists, please call our Consumer Services Department at 1-800-521-2010 in the U.S. or 1-877-352-8697 in Canada, and a service representative will be happy to help you.

IMPORTANT NOTE:

Creating and developing Preschool Learning™ products is accompanied by a responsibility that we at VTech® take very seriously. We make every effort to ensure the accuracy of the information which forms the value of our products. However, errors sometimes can occur. It is important for you to know that we stand behind our products and encourage you to call our Consumer Services Department at 1-800-521-2010 in the U.S. or 1-877-352-8697 in Canada with any problems and/or suggestions that you might have. A service representative will be happy to help you.

NOTE:

This equipment has been tested and found to comply with the limits for a Class B digital device, pursuant to Part 15 of the FCC Rules. These limits are designed to provide reasonable protection against harmful interference in a residential installation. This equipment generates, uses and can radiate radio frequency energy and, if not installed and used in accordance with the instructions, may cause harmful interference to radio communications. However, there is no guarantee that interference will not occur in a particular installation.

If this equipment does cause harmful interference to radio or television reception, which can be determined by turning the equipment off and on, the user is encouraged to try to correct the interference by one or more of the following measures:

- Reorient or relocate the receiving antenna.
- Increase the separation between the equipment and receiver.
- Connect the equipment into an outlet on a circuit different from that to which the receiver is connected.
- Consult the dealer or an experienced radio/TV technician for help.

Caution: changes or modifications not expressly approved by the party responsible for compliance could void the user's authority to operate the equipment.

